

1 How to install

Step 1.
Install bracket

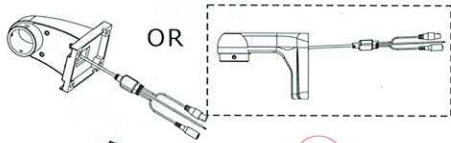

Step 2.
Install camera to bracket

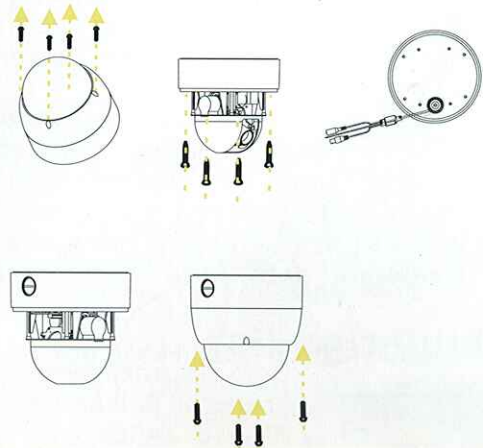
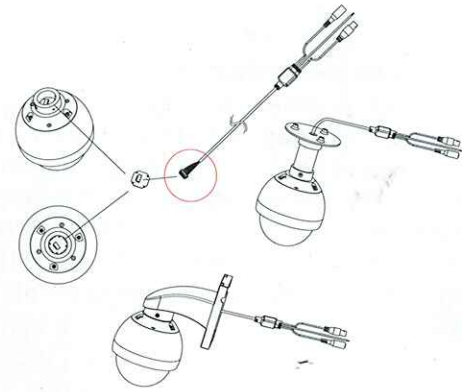
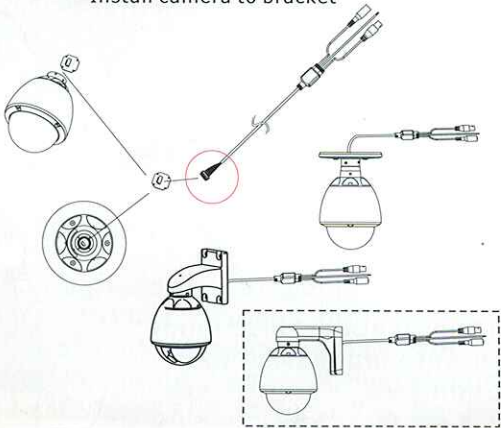

1 How to install

Step 1.
Install bracket on ceiling



Step 2.
Install camera to bracket

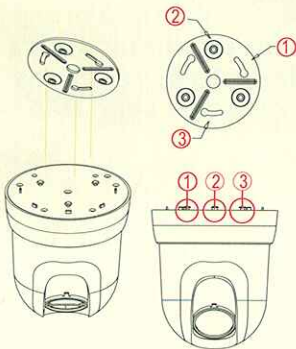

Step 3.
Rotate camera clockwise
until hear a click sound

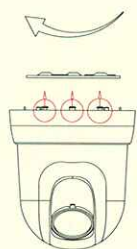

2 How to setup address

Step 1. Remove ceiling mount, Find DIP switch



Remove ceiling mount,
You can find a stick label,
Remove this label, you
can find a DIP switch,
Change DIP switch can
setup Pelco-P/D Address,
Protocol and Baudrate.

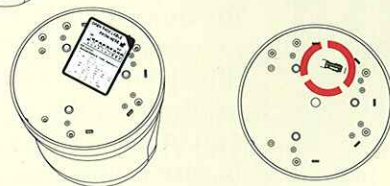

Step 2. Setup protocol

After remove label, you can find a DIP switch, you can configuration address, protocol and baud rate by this DIP switch.

DIP 1 - 6 is address

If address is 1, DIP 1 is ON, another 2-6 is OFF

For Pelco-D, this is protocol address. You need setup same address as DVR. For Pelco-P, this is factual address. Protocol address is this address plus one, For example, If you want set protocol

Pelco-P address 1 at DVR, you need set address 0 at this DIP SWITCH (DIP 1-6 is OFF).

DIP 7-8 is baud rate

	1200	2400	4800	9600
DIP 7	ON	OFF	ON	OFF
DIP 8	OFF	OFF	ON	ON

DIP 9 is protocol ON is Pelco-P, OFF is Pelco-D

DIP 0 is 485 terminal resistance ON is connect 120ohm resistance.

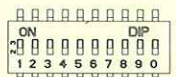

2 Connect Interface



The dome camera cable include power, RS-485, video out.



RS-485 interface is two cable
Red or Green color is 485 A/+
White color is 485 B/-



Video out interface



Power interface,
the dome camera need connect +12V DC
Inside is anode,
Outside is cathode.

The dome camera can be setup address baud rate and protocol from PTZ Controller.

3 How to setup address

The dome camera can be setup address baudrate and protocol by two ways, one is setup by DIP SWITCH, another is setup from PTZ Controller.

How to setup Protocol and Baudrate by DIP SWITCH
Open cover, you can find a DIP switch, you can configuration address, protocol and baud rate by this DIP switch.
DIP 1 - 6 is address,
If address is 1, DIP 1 is ON, another 2-6 is OFF

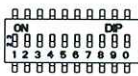

DIP 7,8 is baud rate,	DIP7	DIP8
9600bps	OFF	ON
4800bps	ON	ON
2400bps	OFF	OFF
1200bps	ON	OFF

DIP 9 is protocol, ON is Pelco-P, OFF is Pelco-D

DIP 0 is auto config.

ON is config by DIP switch

OFF is config by RS-485.

4 Function List

The dome camera use preset command to achieve some extended function.

You can use CLEAR / SET / GOTO preset number to do some extended function

Set Preset Point Number Command:

Preset Number Function
1 -- 32 (0x20) Set Preset Point

62(0x3E)	Set Left Limited Point
63(0x3F)	Set Right Limited Point
76(0x4C)	Set Home Point.
77(0x4D)	Set Home Point Wait Time to 64
78(0x4E)	Set Home Point Wait Time to 128
79(0x4F)	Set Home Point Wait Time to 192
80(0x50)	Set Home Point Wait Time to 255
81(0x51)	Enable auto come back Home Point
82(0x52)	Disable auto come back Home Point

92(0x5C)	Set Left Limited Point
93(0x5D)	Set Right Limited Point
94(0x5E)	Reset Original Point

240(0xF0)	Clean Setup
241(0xF1)	Init System

242(0xF2)	Begin PATTERN Setup
243(0xF3)	End PATTERN Setup

247(0xF7)	Start PATTERN
248(0xF8)	Stop PATTERN

Clear Preset Point Number Command:

Preset Number Function
1 -- 32 (0x20) Clear Preset Point

62(0x3E)	Clear Left Limited Point
63(0x3F)	Clear Right Limited Point

76(0x4C)	Clear Home Point
----------	------------------

92(0x5C)	Clear Left Limited Point
93(0x5D)	Clear Right Limited Point

Goto Preset Point Number Command:

Preset Number Function

1 -- 32 (0x20) Goto Preset Point

34(0x22)	Goto Pan Zero point
----------	---------------------

76(0x4C)	Goto Home Point
----------	-----------------

92(0x5C)	Goto Left Limited Point
93(0x5D)	Goto Right Limited Point

99(0x63)	Start Auto Scan
----------	-----------------

Pattern function:

You can do like this setup pattern point:

- Step 1: Input SET preset 242 begin pattern learning
- Step 2: You can send GOTO preset point command, camera will auto record this point as pattern point.
For example: If you want camera tour at point 1,3,6 You can input GOTO preset point 1, GOTO preset point 3, GOTO preset point 6 at this time.
- Step 3: Input SET preset 243 end pattern learning
- Step 4: Input SET preset 247 start pattern tour running,
- Step 5: Input SET preset 248 stop pattern tour.

Also we support Pelco pattern command:

Send Set Pattern Start command(00 1F 00 00)
start pattern learning, When camera at this mode,
You can send GOTO preset point command,
camera will auto record this point as pattern point.
Send Set Pattern Stop command (00 21 00 00)stop
pattern learning,
Send Run Pattern command(00 23 00 00) start/stop
pattern running.